

EC-ESS34PS

1/4 & 3/8" Square Drive 34 Piece Socket Sets

Spark Plug Sockets

Designed specifically for working with spark plugs in vehicles, Spark Plug Sockets are deeper in length to accommodate the spark plug and have a rubber lining to ensure a secure fit, absorb vibration, and reduce any possibility of damaging the spark plug (especially the glass featured along the spark plug)

Universal Joint

Flexible 180° twisting connector that allows for working at awkward angles or in hard-to-reach places. Fit directly onto the Ratchet and Extension Bars.

Bit Holder (Adaptor)

Connect to the Ratchet Handle or Extension Bar to use the various Bits

Extension Bars

Affix to the Ratchet Handle or Spinner Handle to reach fasteners in confined or awkward spaces that are difficult to access

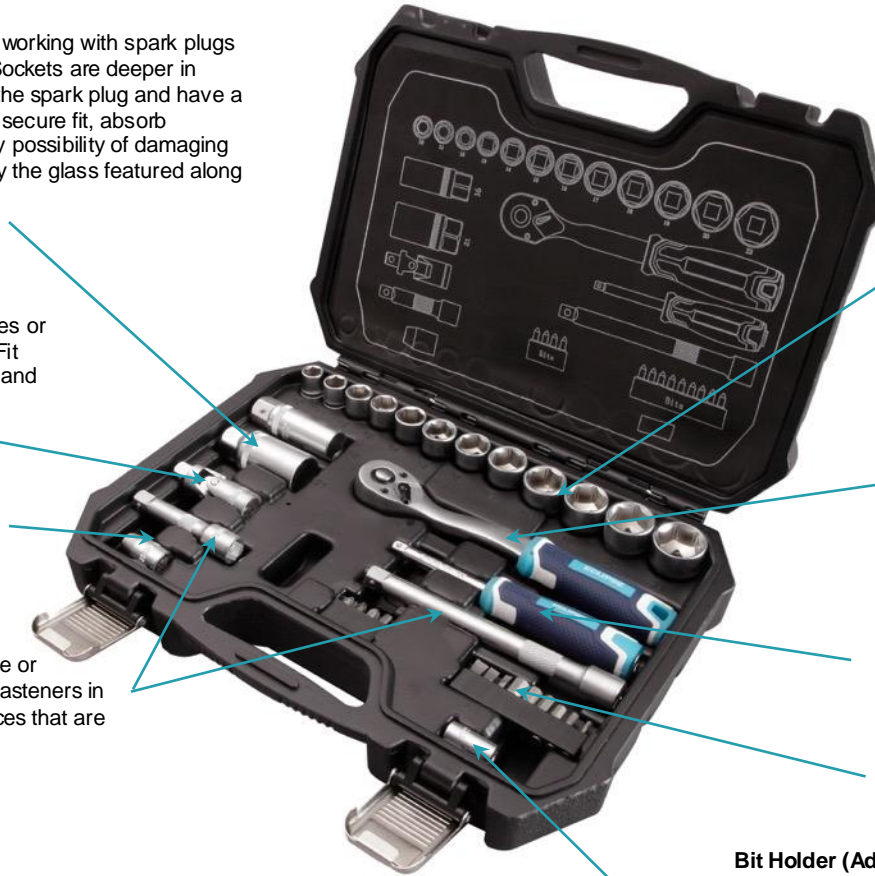

12 x Sockets (10 – 22mm)

The sockets featured in our Eclipse socket sets are six-point hex, meaning that the sockets have six angles/faces inside the bolt end

72T Ratchet Handle

Our Eclipse Ratchet Handles have 72 teeth on the drive gear, meaning that the handle must move just 5° to engage the next tooth

Spinner Handle

Works like a screwdriver when used with the Bit Holder and 25mm Bits

13 x 25mm Bits

FD 4, 5.5, 7, PH1, PH2, PH3, PH4, Hex 3, 4, 5, 6, 7, 8

Bit Holder (Adaptor)

Connect to the Spinner Handle to use the various Bits

RRP \$86.98

Barcode: 5012095630012

Logistical Information

Part No.	Single item no packaging				Single item with packaging				Inner pack (Carton)				Outer (Transit) pack where applicable					
	Length (mm)	Width (mm)	Height (mm)	Weight (kg)	Length (mm)	Width (mm)	Height (mm)	Weight (kg)	Qty. per inner pack	Length (mm)	Width (mm)	Height (mm)	Weight (Kg)	Qty. per outer pack	Length (mm)	Width (mm)	Height (mm)	Weight (Kg)
EC-ESS34PS	N/A	N/A	N/A	2.43	330	245	80	2.43	5	340	260	440	25.5	N/A	N/A	N/A	N/A	N/A

